

# nitto instruments VA/SA/FA10S Series Glass Rotameter

## 10S Specification

D N (mm)	Model	Measure Range		Working Pressure (Bar)	Temp.
		Water (L/h)	Air (m³/h)		
15	VA10S-15	4~40	0.12~1.2	≤10	-20°C ~180°C
	SA10S-15	6~60	0.3~3		
	FA10S-15	10~100	0.5~5		
	FA10S-15	25~250	0.8~8		
25	VA10S-25	63~630	2~20	≤10	-20°C ~180°C
	SA10S-25	100~1000	3~30		
	FA10S-25	160~1600	5~50		
	FA10S-25	250~2500	8~80		
40	VA10S-40	160~1600	5~50	≤9	-20°C ~180°C
	SA10S-40	250~2500	8~80		
	FA10S-40	400~4000	12~120		
50	VA10S-50	400~4000	12~120	≤7	-20°C ~180°C
	SA10S-50	630~6300	20~200		
	FA10S-50	1000~10000	30~300		
	FA10S-50	4000~16000	30~300		

## VA/SA/FA10S,20S,VA30S,GA24S,GA24V

glass rotameter are the new products of our company.compared with the other domestic products of the same type,it has advantages of high measuring precision, good interchangeability,multiple connection ways,especially the value of flow rate of the flow meter is in millimeter scale mark,which is capable of providing actual flow scale according to the temperature,pressure,density, and viscosity of different flows, solving the problem of indication correction. As for the ways of connection, VA10S and VA20S use pipe thread connection, SA10S and SA20S use flexible pipe connection, while FA10S and FA20S use flange connection. The loose flange structure is available, with both conventional type and corrosion-proof type.

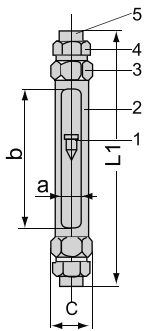

### VA10S Installation Size Screwed end

D N (mm)	Window Size axb	VA10S Pipe Thread Connection			
		L1	C	Pipe Thread	Weight(Kg)
15	26x230	408	53	1/2" FNPT BSP1/2"	1
25	26x230	414	75	1" FNPT BSP1"	1.1
40	40x230	428	92	1 1/2" FNPT BSP1 1/2"	3.7
50	50x230	431	116	2" FNPT BSP2"	5.9

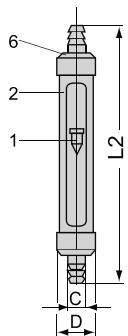

### SA10S Installation Size Hose end

D N (mm)	window size axb	SA10S flexible pipe connection			
		L2	C	D	weight(Kg)
15	26x230	400	∅ 13.5	∅ 44	0.9
25	26x230		∅ 27	∅ 65	1.6
40	40x230	450	∅ 44	∅ 80	3.4
50	50x230		∅ 53	∅ 103	5.2

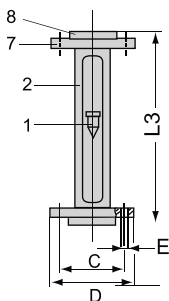

### FA10S Installation Size Flanged end

D N (mm)	window size axb	FA10S flange connection				
		L3	C	D	E	weight(Kg)
15	26x230	310	∅65	∅95	4-∅14	1.4
25	26x230		∅85	∅115	4-∅14	2.6
40	40x230		∅110	∅145	4-∅18	4.6
50	50x230		∅125	∅160	4-∅18	7.3

### 10S Materials

No.	Material	No.	Material
1	304SS,316L or PTFE	5	304SS or 45#
2	Steel Pipe	6	304SS or AL
3	AL or 304SS	7	45# or 304SS*
4	45#	8	AL or 304SS



### Ordering

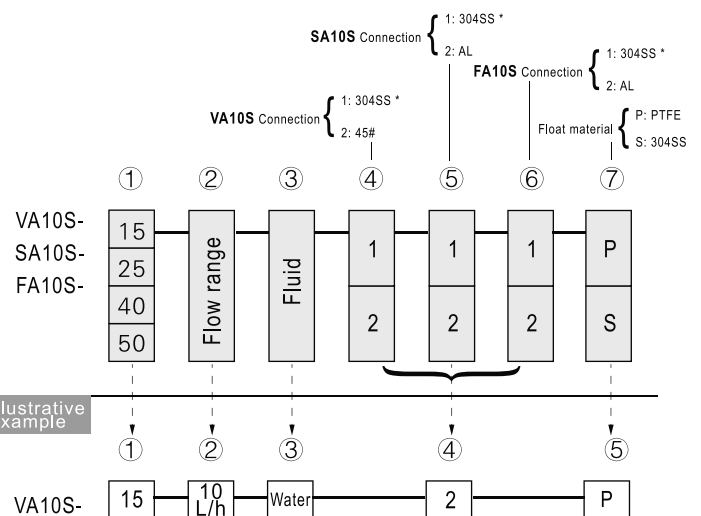

\*\* Special ordering.

\* Refer to "Ordering" and "Illustrative example" when placing an order or requesting a quotation. Fill in the blanks in the "Order/Quotation Request Card" at the end of the catalog, and send the card by fax.