



APPLICATIONS

Usage monitoring, such as:

- Industrial wastewater discharge monitoring
- Cooling tower deduct metering
- Heap leach mining discharge monitoring
- Well monitoring
- Turf and landscape water monitoring

FEATURES

- Simple as a mechanical meter
- No moving parts
- Minimal straight pipe required
- Battery powered
- Built-in rate & total indicator
- Corrosion resistant

GENERAL INFORMATION

The WMP-Series is a full-bore, plastic-bodied electromagnetic flow meter designed for flow and usage monitoring applications in 1 and 2 inch pipe. The polypropylene flow tube offers corrosion resistance to a wide range of chemicals. Its light weight and easy to install or remove from the pipe for inspection*.

With no moving parts, the magmeter permits unobstructed flow, minimizing flow disturbances and hence, straight pipe requirements. The WMP-Series can be used in piping configurations where there is little space between the meter and an elbow or valve. The WMP-Series, like other magmeters, are resistant to wear from sand and debris found in ground or surface water. Since there are no bearings or propeller to wear out, downtime and maintenance and repair costs are kept to a minimum. Because there are no mechanical parts in the flow stream, the meter tolerates high flows without damage.

The hinged, opaque polyethylene cover protects from dust and UV rays, while permitting easy access to the LCD flow rate and total display. The electronics housing is made of rugged powder-coated die-cast aluminum. It can be fitted with cross-drilled screws and seal wire for tamper-evidence. Flow

rate and total can be displayed in a variety of units, customer-selected and factory-set.

The WMP-Series is used for tracking flow rate and total flow in usage monitoring applications, for instance, in compliance with regulatory requirements. These would include wells, industrial wastewater, heap leach mining discharge, cooling tower deduct metering, turf and landscape applications, and other water reclamation operations. In the event of DC power loss, or when changing the battery, the WMP is designed to retain the internal settings and flow total.

The **WMP101** is externally powered via a 5-pin connector and the power cable also provides pulse output for use with a variety of Seametrics and other displays and controls for remote reading, data logging, pulse-to-analog conversion, and telemetry applications.

The **WMP104** is a battery-operated unit for use when pulse output is not required. The standard batteries are user replaceable with an approximate 1-year life under typical use. An Extended Battery Life option offers an estimated 3-year life, depending on the duty cycle.

**Use Banjo® fittings or Seametrics WMP Fittings Kit*

FEATURES

Polyethylene protective cover

LCD rate and total indicator

Powder-coated diecast-aluminum electronics housing

Cross-drilled screws (2) for tamper-evidence

316SS electrodes

Corrosion-resistant glass-filled polypropylene body
Lightweight for easy handling



**Seametrics Fitting Kit
for 2 inch model**

SPECIFICATIONS*

Pipe Size	1 or 2 inch full port		
Fittings	1 inch NPTF, 2 inch flange clamps with optional 2 inch NPTF fitting kit		
Pressure	150 psi or 10.3 bar working pressure @ 70° F		
Operating Temperature Range	10° to 130° F (-12° to 54° C) operating, -40° to 176° F (-40° to 80° C) non-operating		
Accuracy	+/-1% of reading from 100% to 10% of full scale		
	+/-3% of reading from 10% of full scale to cut off		
Flow Range	Minimum	1 inch: 2.3 gallons per minute (.145 liters per second)	2 inch: 6 gallons per minute (.38 liters per second)
	Maximum	1 inch: 110 gallons per minute (6.94 liters per second)	2 inch: 300 gallons per minute (18.9 liters per second)
Materials	Body	Glass-filled polypropylene	
	Electrodes	316 stainless steel	
	Electronics Housing	Diecast aluminum, powder-coated	
	Display Cover	Polyethylene	
Display	Rate		Total
	Digits	6	8
	Units	Gallons/Minute, Cubic Feet/Second, Cubic Feet/Minute, Liters/Second Liters/Minute, Cubic Meters/Minute	Acre-Feet, Acre-Inch, Gallons, Gallons x 1000, Cubic Feet, Liters, Megaliters, Cubic Meters
Security	Cross-drilled screws and tamper-evident seal (optional)		
Power	WMP101	10-30 Vdc @ 60 mA max (15 mA average) NOTE: Using an unregulated power supply >18 Vdc may damage the meter due to AC line input voltage fluctuation	
	WMP104	6 each AA alkaline cells, replaceable. Estimated life is 1-year with meter in typical use, or 3-years dry.	
		2 each C lithium batteries, replaceable. Estimated life is 3-years with meter in typical use, or 10-years dry	
Pulse Output (WMP101 Only)	Signal Pulse Rate	Current sinking pulse, opto isolated, 24 Vdc at 10 mA max 1 gal/pulse out, or 1 liter/pulse out, depending on unit selection. Pulse width of 10ms	
High Frequency Output (WMP101 Only)	Optional, 30 PPG, pulse width 1.1 ms, min - max frequency, 3 - 150 hz		
Empty Pipe Detection	Hardware/software, conductivity-based		
Conductivity	>20 microSiemens		
Environmental	NEMA 4X standard; -40° to 176° F (-40° to 80° C) storage		
Electrical Connection (WMP101 Only)	5 pin male circular connector, mates to industry standard cable		

*Specifications subject to change • Please consult our website for current data (www.seametrics.com).



WMP-Series Plastic-Bodied Magmeter

DIMENSIONS

1 Inch

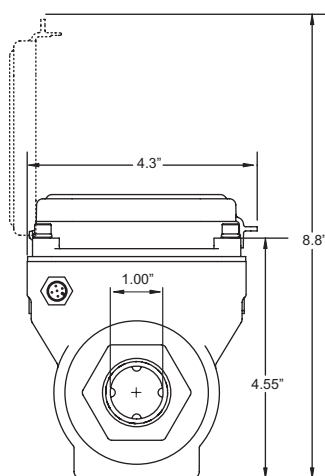

Power/Output Cable
- WMP101 Only

2 Inch

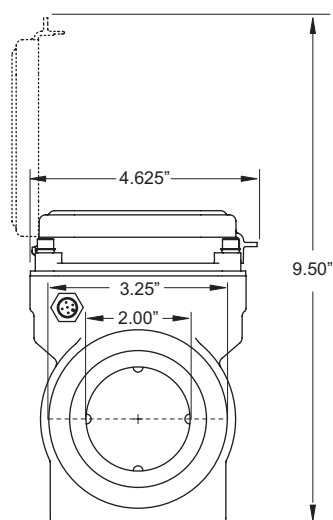

Use Banjo® fittings or
Seametrics WMP Fitting Kit

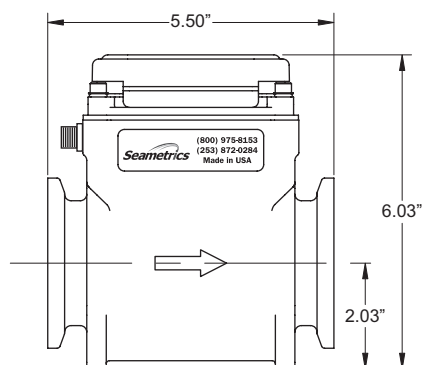
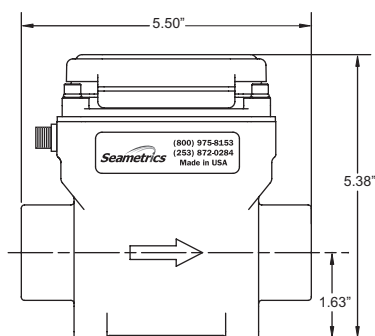

STRAIGHT PIPE RECOMMENDATIONS

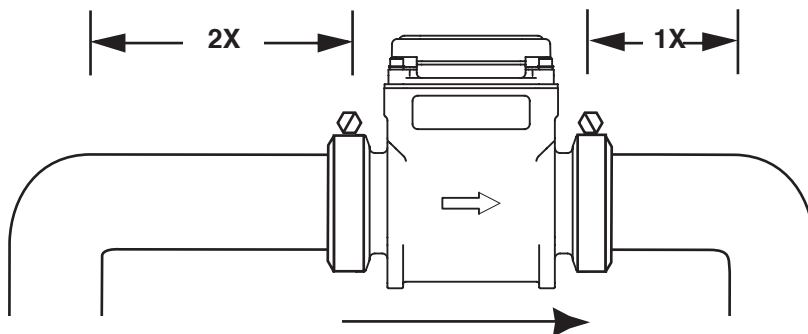

*Minimal straight pipe
required between elbows.
For other piping configurations,
consult factory.*

FLOW RANGE

	1"		2"	
	Gal/Min	Liter/Sec	Gal/Min	Liter/Sec
Minimum	2.3	.145	6	.38
Maximum	110	6.94	300	18.9



WMP-Series Plastic-Bodied Magmeter

HOW TO ORDER

MODEL	SIZE	OPTIONS	UNITS																																				
External Power = WMP101	1" = -100	Tamper-evident seal, screws, and wire = -32	<table><thead><tr><th>RATE</th><th>ORDER</th><th>TOTAL</th><th>ORDER</th></tr></thead><tbody><tr><td>Gal/Min</td><td>= GPM</td><td>Gal</td><td>= G</td></tr><tr><td>Liters/Sec</td><td>= LPS</td><td>Gal x 1000</td><td>= GT</td></tr><tr><td>Liter/Min</td><td>= LPM</td><td>Cubic Feet</td><td>= CF</td></tr><tr><td>Cu Ft/Sec</td><td>= CFS</td><td>Acre Inch</td><td>= AI</td></tr><tr><td>Cu Ft/Min</td><td>= CFM</td><td>Acre Feet</td><td>= AF</td></tr><tr><td>Cu Met/Min</td><td>= CMM</td><td>Liter</td><td>= L</td></tr><tr><td></td><td></td><td>Mega Liters</td><td>= ML</td></tr><tr><td></td><td></td><td>Cubic Meters</td><td>= CM</td></tr></tbody></table>	RATE	ORDER	TOTAL	ORDER	Gal/Min	= GPM	Gal	= G	Liters/Sec	= LPS	Gal x 1000	= GT	Liter/Min	= LPM	Cubic Feet	= CF	Cu Ft/Sec	= CFS	Acre Inch	= AI	Cu Ft/Min	= CFM	Acre Feet	= AF	Cu Met/Min	= CMM	Liter	= L			Mega Liters	= ML			Cubic Meters	= CM
RATE	ORDER	TOTAL	ORDER																																				
Gal/Min	= GPM	Gal	= G																																				
Liters/Sec	= LPS	Gal x 1000	= GT																																				
Liter/Min	= LPM	Cubic Feet	= CF																																				
Cu Ft/Sec	= CFS	Acre Inch	= AI																																				
Cu Ft/Min	= CFM	Acre Feet	= AF																																				
Cu Met/Min	= CMM	Liter	= L																																				
		Mega Liters	= ML																																				
		Cubic Meters	= CM																																				
Battery Power = WMP104	2" = -200	Extended Battery Life = -133																																					
		High frequency output = -HF																																					

Consult factory for additional units.

ACCESSORIES

20 foot (6m) cable for WMP101 = 32482	Remote 4-20 mA (analog) signal = AO55W (-HF Option Required)
Seametrics WMP Fitting Kit = 31980 (for 2 inch model)	Remote Rate and Total Indicator = FT420W (-HF Option Required)
2 FNPT threaded adapters	Remote Data Logger = DL76W
2 flange clamps	
2 EPDM gaskets	

CONTACT YOUR SUPPLIER